

Project Release Notes

Release 3.6 (June 2021)

What's new

Current record literal

The newly introduced `#{CURRENTRECORD}` literal represents the record currently being edited by the app user. You can use it in filters to narrow the lookup scope to match the current record's context. Hence improving productivity and providing a smoother user experience.

For example, in a service request, you can trim the Assets lookup to list equipment installed at the location entered by the user. Similarly, in a Diagnostic test booking app, you can limit the Lab lookup values based on the ZIP Code entered.

[Read more...](#)

Current record literal

The newly introduced `#{CURRENTRECORD}` literal represents the record currently being edited by the app user. You can use it in filters to narrow the lookup scope to match the current record's context. Hence improving productivity and providing a smoother user experience.

For example, in a service request, you can trim the Assets lookup to list equipment installed at the location entered by the user. Similarly, in a Diagnostic test booking app, you can limit the Lab lookup values based on the ZIP Code entered.

The `#{CURRENTRECORD}` literals are supported in Create, Edit, and Fork actions.

Using the literal

You can use the literal to refer to the fields from the user action's main object and its related objects. You will need to append the field API name to the literal as a dotted suffix, like so: `#{CURRENTRECORD.field_api_name}`.

Look for the API names in the Object modeler. The object's API name appears under the List of objects and the field API name in the field's Properties panel.

If `mfuwc_city` is the City field's API name, the literal notation to refer to its value is `>#{CURRENTRECORD.mfuwc_city}`.

Similarly, for a related object's field, append the related object's API name followed by that field's API name. For example, if `mfuwc_branchoffice` and `mfuwc_city` are the API names of the related object and its field, the literal notation is `#{CURRENTRECORD.mfuwc_branchoffice.mfuwc_city}`.

Note:

When you use the `#{CURRENTRECORD}` literal in a lookup filter, if the field referred by the literal is blank, the lookup will also be empty. For instance, a lookup filtered on the ZIP Code field will remain empty until the user enters the field value.

Filtering records

In filters, the `#{CURRENTRECORD}` literal is supported for fields of type Text and Date. You can use the literal on the right-hand side of the filter expression for these field types. Setting the literal for any other field type will result in an error.

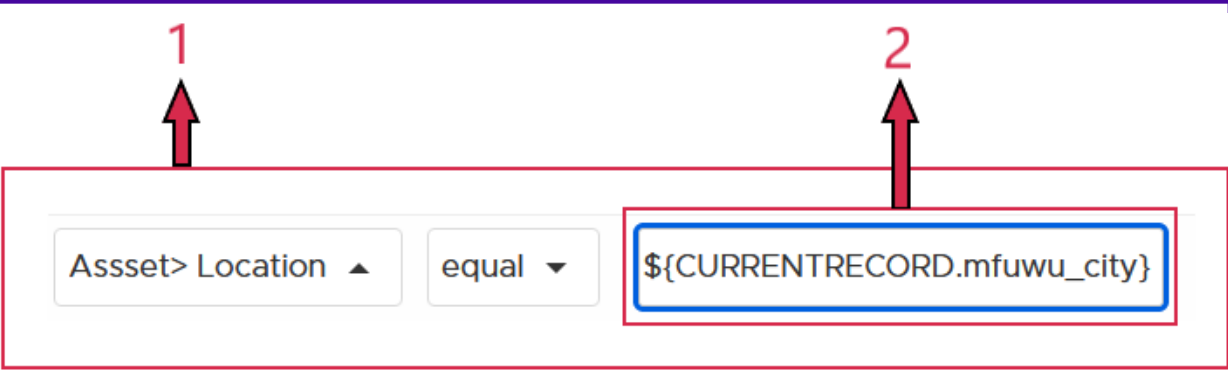

The image shows a filter expression interface. On the left, there is a dropdown menu with 'Asset> Location' and an upward arrow. Next to it is another dropdown menu with 'equal' and a downward arrow. To the right is a text input field containing the text `#{CURRENTRECORD.mfuwu_city}`. A red arrow labeled '1' points to the 'Asset> Location' dropdown. Another red arrow labeled '2' points to the text input field.

Figure 1. Using the current record literal in a filter expression

1. Filter expression	2. <code>#{CURRENTRECORD}</code> literal for City field
----------------------	---

Support info

Supported clients	Android, iPad, iPhone, and Web client
Supported data sources	Flex and RDS

Limitations

- Support for using `#{CURRENTRECORD}` literal in Oracle and Salesforce data sources is currently not available.
- The `#{CURRENTRECORD}` literal is not supported as of this release for field types other than Text and Date.

The limitations listed above will be supported in the coming releases.

Notes for app users

When you use `#{CURRENTRECORD}` literal in the lookup pre-filter, the app users will experience the following:

- The lookup records are specific to the current record's context
- The list of lookup records that appear and may vary based on the value entered by the user
- If the dependent field is empty, the lookup will also be empty

App update info

Android and iOS app users will need to update their Appify apps to the following versions:

App	Platform	Version
Appify Mobile for Phones	Android	v3.6.4
Appify Mobile for Phones	iPhones	v3.6.3
Appify Mobile for Tablets	iPad	v3.6.3

In-line lookup

App users can now directly enter a value in lookup fields and choose a record from the matching list that appears in-line. Your app users can now enjoy a smoother and more productive lookup experience.

With in-line support, updating lookup fields is thrice quicker than without. For instance, consider an Asset record with 8 lookup fields such as Account, Contact, Product, and Location, users will be able to update them with just 8 clicks instead of 24.

The in-line ability in the lookup field is available by default in Create, Edit, Fork, and List actions.

Entering a value

Users can tap or click the lookup field and type the value directly into it. A list of incrementally matched records appears below the lookup field. The first two display fields configured for the lookup appear in the list for matching records.

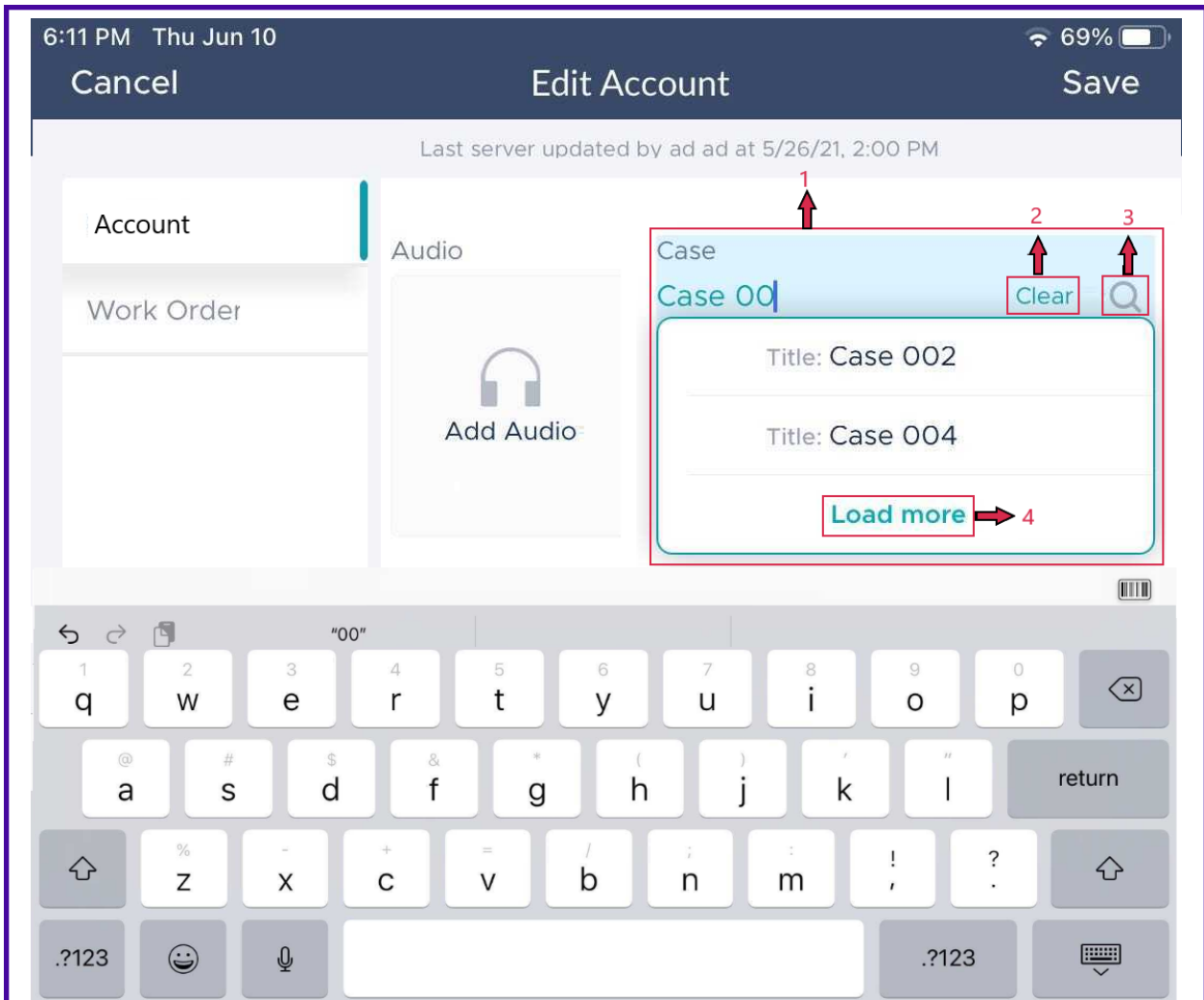

Figure 1. Lookup with an entered value and a list of matches on the iPad

1. Lookup field with matches

2. Clear button

3. Lens icon opens the lookup panel

4. Load more button opens lookup panel

A single matching record is automatically chosen when users tap / click out of the field. However, when there are multiple matches, users are prompted to choose from the list if they haven't done so.

Users can still use the lookup search panel to see the complete list of matching records and all the configured display fields by clicking the Lens icon. They can use the Clear button / icon and the Undo button / icon to erase a lookup entry and undo the recent action.

Viewing matches

The matching records list is limited to 10 on the web client and 2 on mobile client apps. To see all the matching records, users can use the Load more button at the bottom of the list.

Copying fields

Configured copy fields are populated automatically after the user chooses a valid value in the lookup field.

Support info

Supported clients	Android, iPad, iPhone, and Web client
Supported data sources	Flex, Oracle, Salesforce, RDS

Fixed issues

The following customer issues are fixed in this release:

Issue ID	Product area	Issue description
CD-1339 CD-1419	Web client	Generating a new record using Fork action was very slow. It took more than 60 secs when the number of child records exceeded 500. After we optimized the performance, it now takes less than 14 secs.
CD-1650 CD-1654	Web client	App users were not able to add or delete records in the child sections of Edit actions.
CD-1677	Web client	Default field values set using the <code>#{CURRENTRECORD}</code> literal were not populated in child sections of Edit actions when a new line was added via auto-line create.
CD-1687	Web client	Saving edited records failed if there was a Save action configured for it using an external API.
CD-1702	Android	A notification saying "Multimedia Downloading" repeatedly appeared when users signed in, created new records, or initiated data sync when the app included attachments and multimedia fields in the same action.
CD-1713	Web client	Fields were left blank in forked records if the reference field selected in 'Copy value from' was not used in the Fork action's layout.
CD-1719	Web client	Reference field values were not populated if the configured field calculation included another reference field.

CD-1758	iPad	Boolean fields values were set to 'NO' by default when there was no default value set. Nothing should have been selected automatically.
CD-1793 CD-1799 CD-1803	Web client	Default value set for a field in Edit action was not applied when the action was executed silently. After save, the field still displayed the earlier value instead of the set default.